

CSI 6-n

Cold start igniter for electronic lamp power supplies

Technische Daten / Technical data

Lampenstrom. / Lamp current	6 A max.
Frequenzbereich / Frequency	1 – 400 Hz
Eingangsspannungsbereich / Input voltage range	230 – 350 V
Umgebungstemperatur / Ambient temperature	50°C max
Zündspannung / Ignition voltage	3kV and 5kV

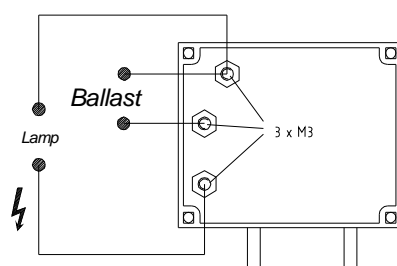
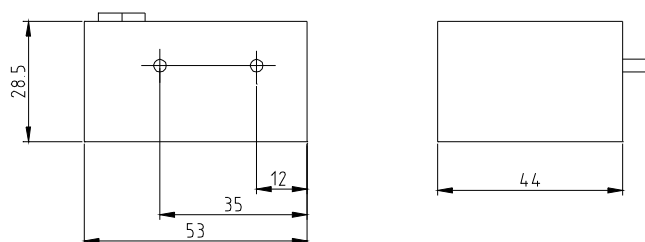

Order Information

CSI 6-3	Art. Nr. / Ord. no	20 101 0003	3 kV
CSI 6-5	Art. Nr. / Ord. No.	20 101 0005	5 kV

Technische Änderungen vorbehalten / Subject to changes without notice